

# Rotating Nozzle PRD 3000 for gun operation

Z 20-2 e

10.02.2009

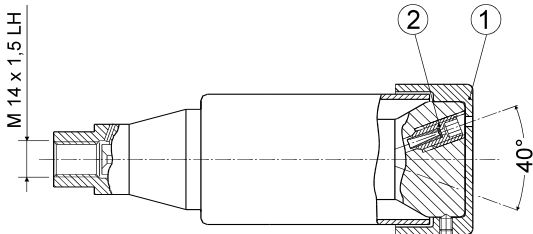

Item	Description	Part No.
	Rotating nozzle PRD 2500 includes item (1)	7006429
1	Protective cover	7006415
2	Straight jet screwed nozzle type 0965 (M 10) Standard configuration : 4 x 0.4 mm or 2 x 0.6 mm + 2 x plug	70062.. (see Z55-1 e)

### Nozzle selection:

The rotating nozzle can be equipped with 4 screwed nozzles or with 2 screwed nozzles and 2 screwed plugs. For correct nozzle diameter selection use the operating diagram. The grey section of this diagram shows the permissible operating area of the nozzle.

### Operating diagram for nozzle selection

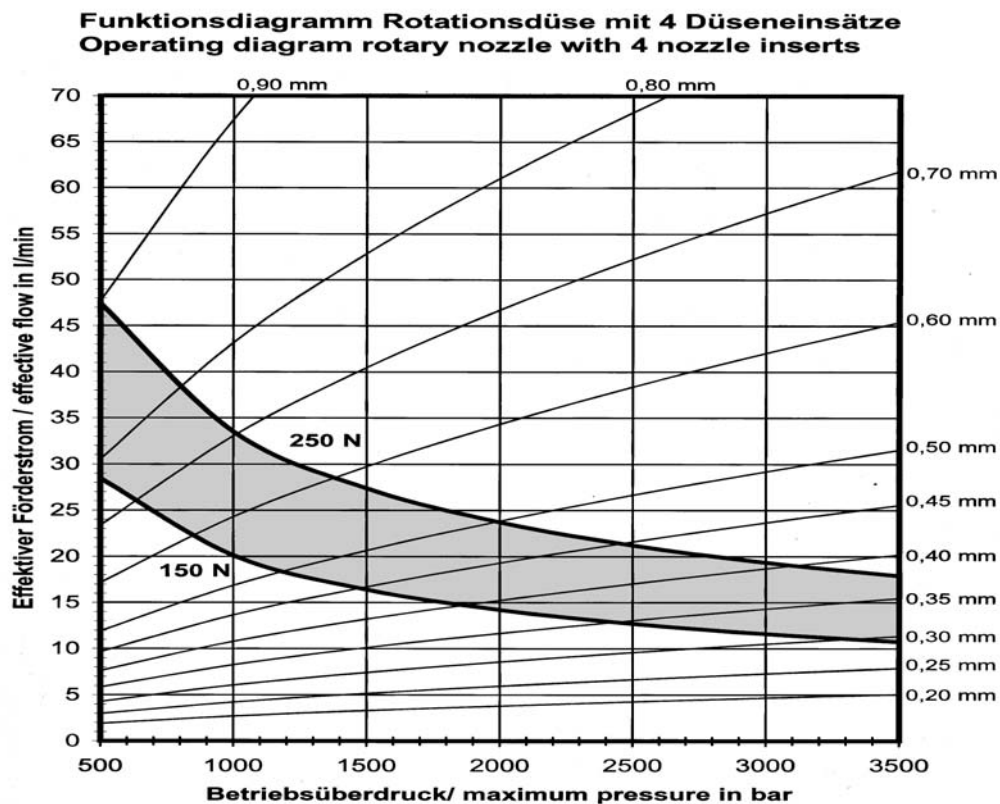

For hand-held operation of a spray gun the nozzle diameter must be selected to ensure that the reaction force in the longitudinal axis when used at the max. operating pressure does not exceed 250 N. If the reaction force is in excess of 150 N the gun must be equipped with a support, in compliance with the European Norm prEN 1829.