

Rotating Joint 5/2500

Z 65-2 e

01.04.2008

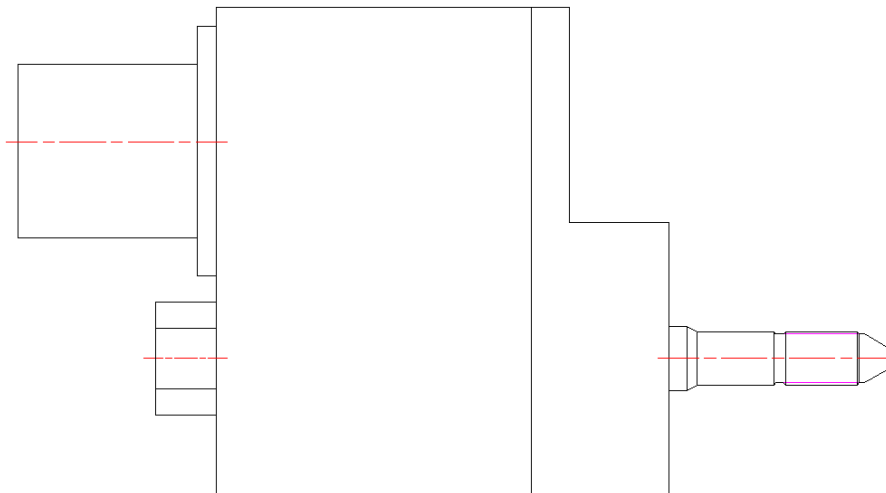

Technical data

Part No.:	7008786
Max. working pressure:	2500 bar
Nom. diameter:	ID 5 mm
Connection inlet:	M 14 x 1.5 left, female
Connection shaft side:	M 14 x 1.5 left, male
Important:	No traverse loads permitted!
Length:	192 mm (275 mm)
Weight:	approx. 5.5 kg

Pneumatic Drive:

Speed rpm:	0 - 3000 rpm
Air connection:	Quick coupling for air hose ID 6
Air requirement:	8,3 l/s
Air working pressure:	6.3 bar

Note

Rotating arms, nozzle holders etc. can be designed to specification